

2.4-2.5GHz SECTOR 12-15 dBi FOR N FEMALE



Specifications/Special Features :

This antenna is designed for wireless WIFI communications

Specification	
Model No.	SA-24-01
Gain (dBi)	12-15 dBi
Type	Sector
Polarization	Vertical
Vertical Beam width deg.	13 - 20°
Horizontal Beam width deg.	45 - 120°
V.S.W.R.	<1.5 : 1
Operating Temperature	-30°c ~ +70°c
Frequency	2400~2500MHz
Antenna Connector	N Female
Max Power	50W
Impedance	50Ω
Radome Material	UV Polymer
Dimensions	L424×W265×H76 mm
Mounting	L type and U-bolts
Weight	1900g

SA-24-01

2.4-2.5GHz SECTOR 12-15 dBi FOR N FEMALE

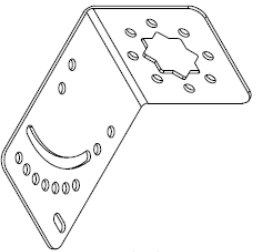
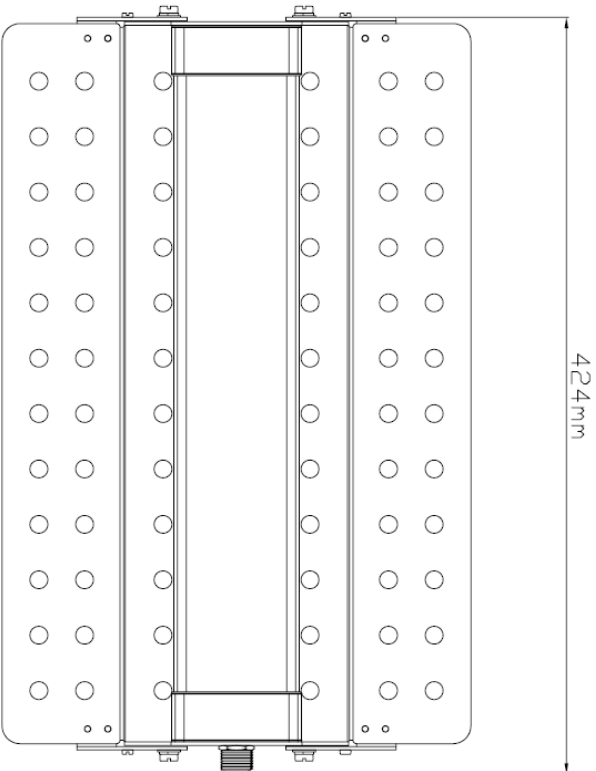
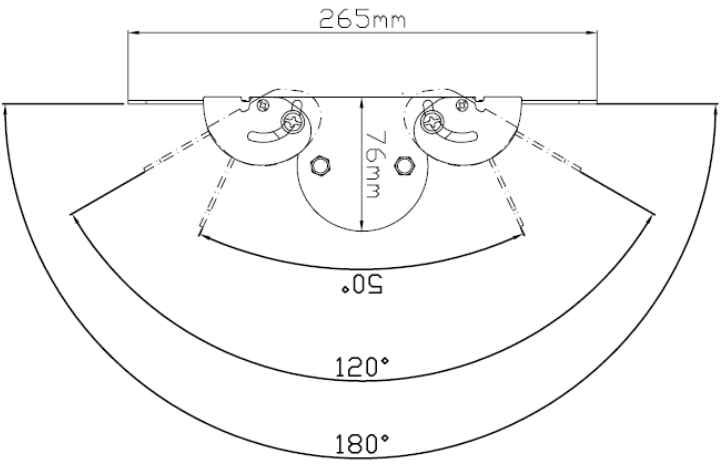

X2

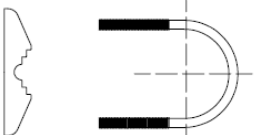

X2

X2

WASHER X4

NUT X8

NUT X4

1	FREQUENCY : 2400-2500MHz	6	IMPEDANCE : 50 Ω
2	GAIN : 12-15dBi	7	
3	V.S.W/R : ≤1.5:1	8	
4	ANTENNA LENGTH : L424xW265xH76 mm	9	
5	CONNECTOR : N FEMALE	10	

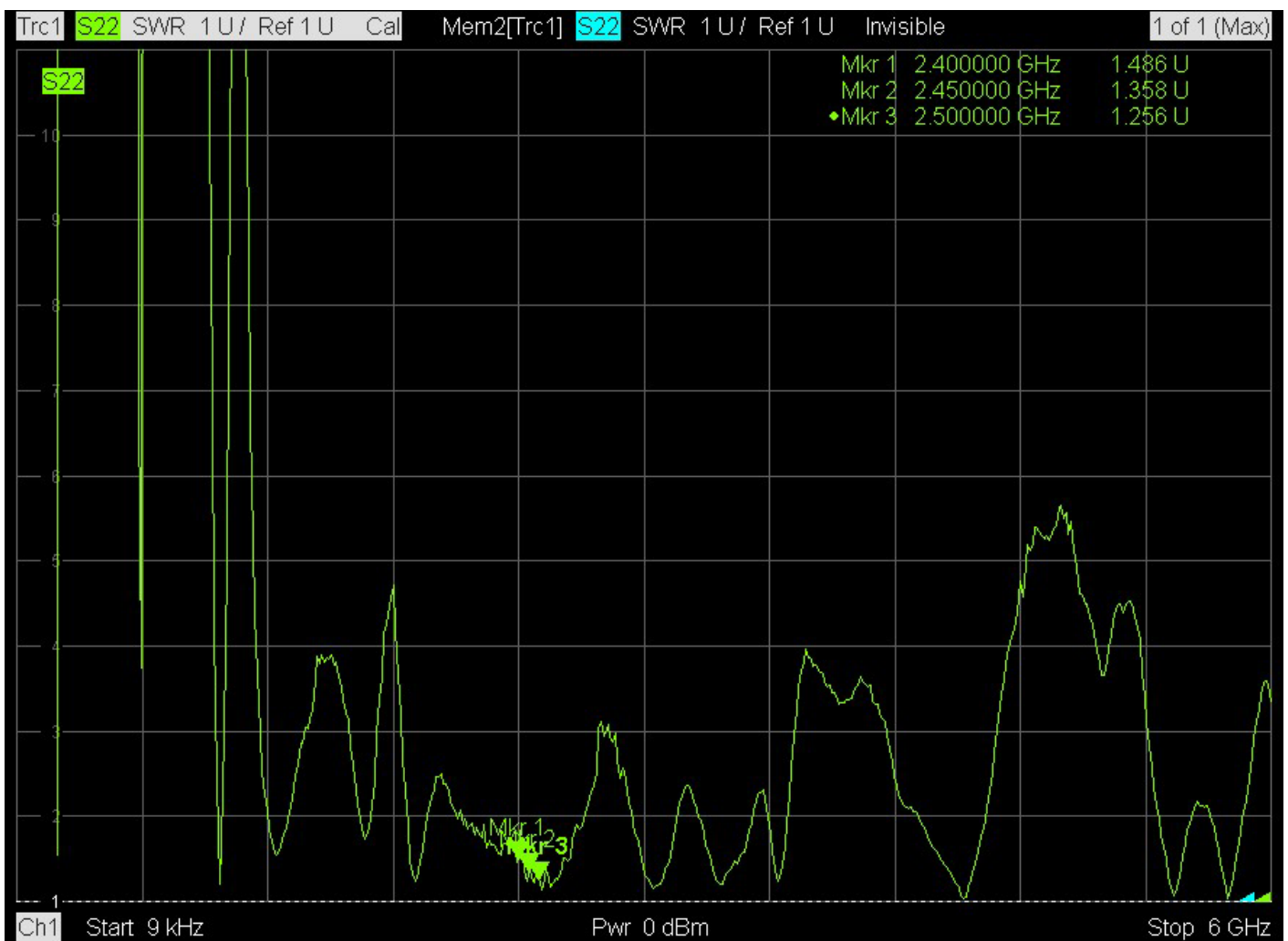
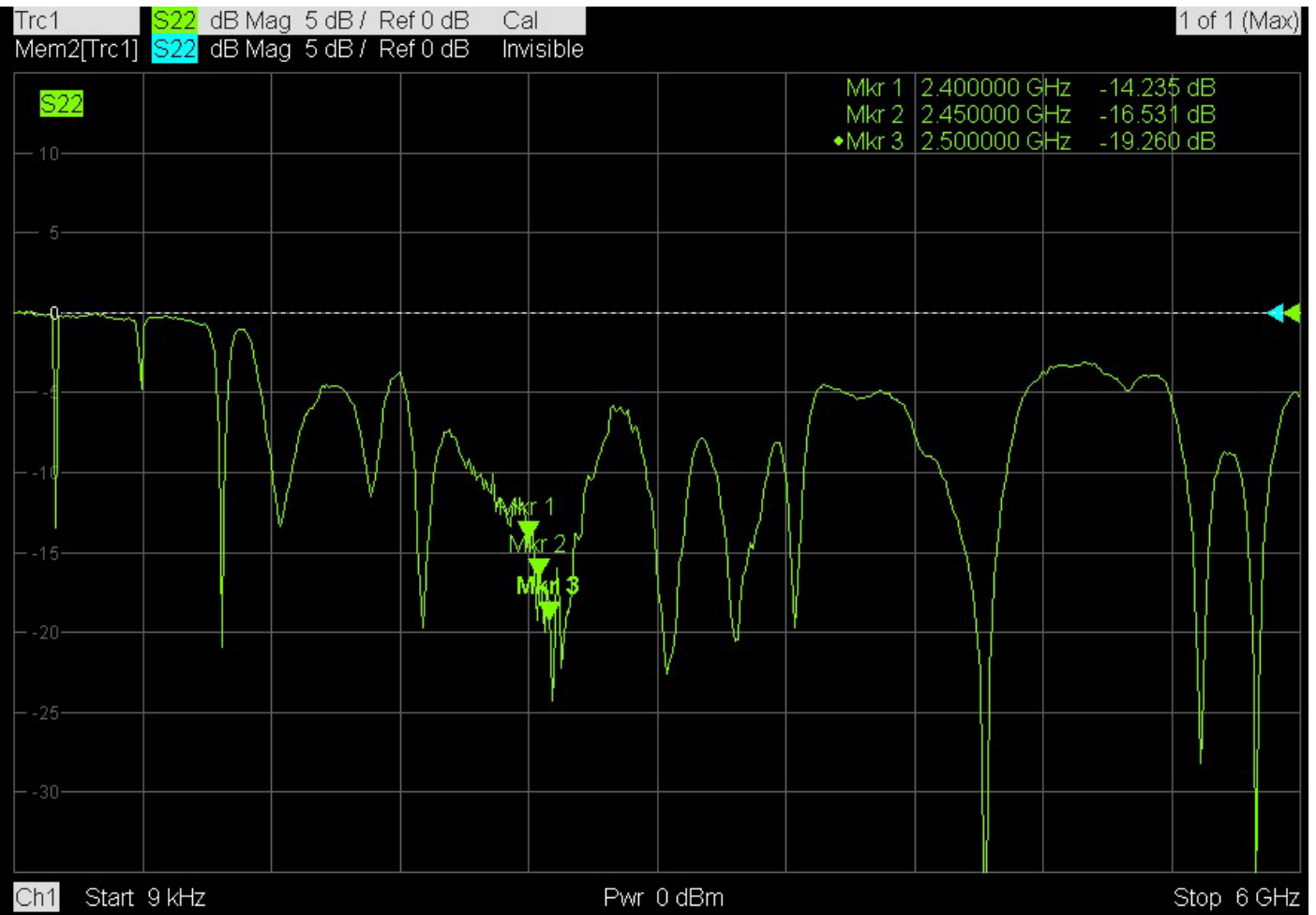

Fan angle: 120deg

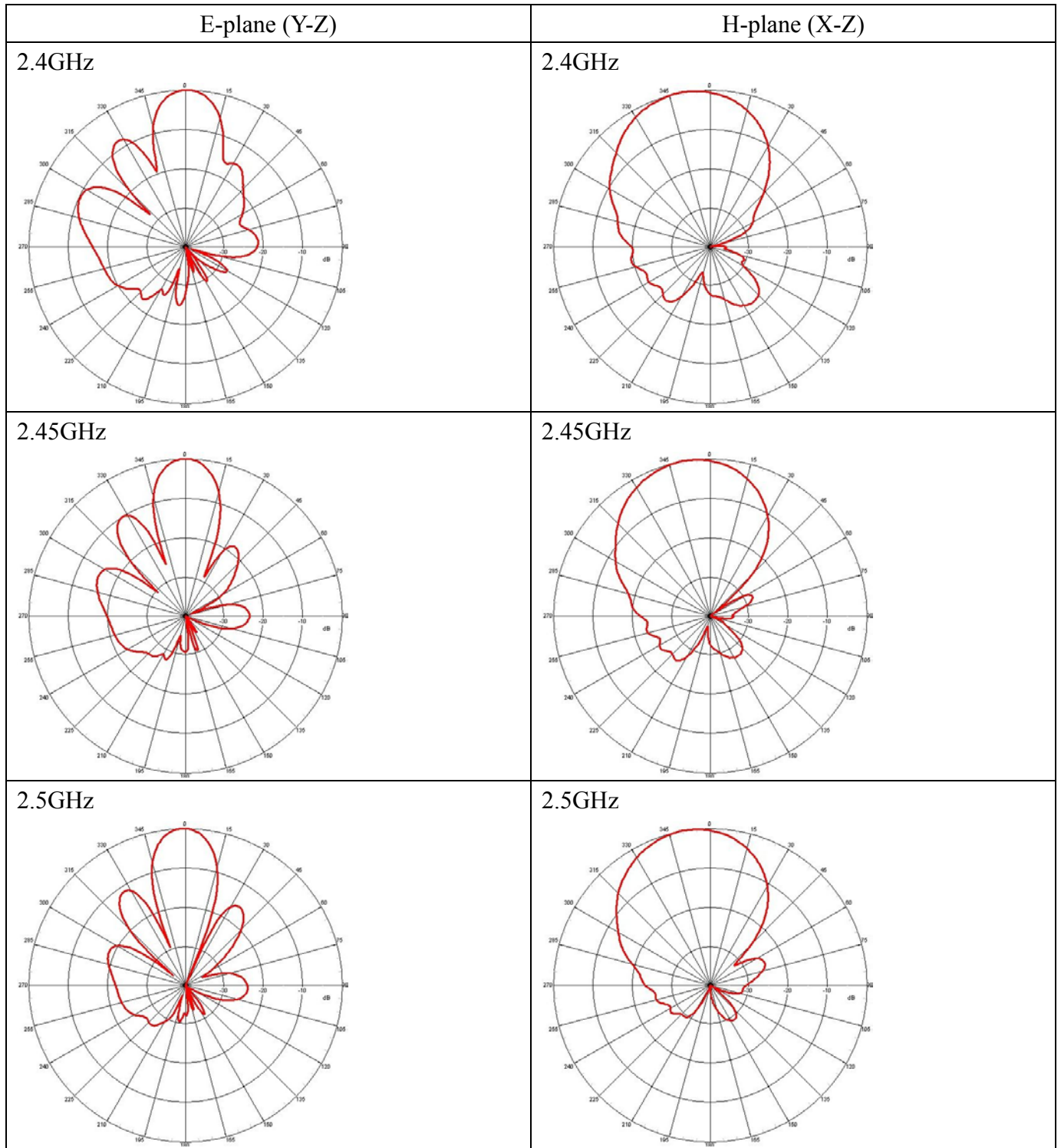

Fan angle: 140deg

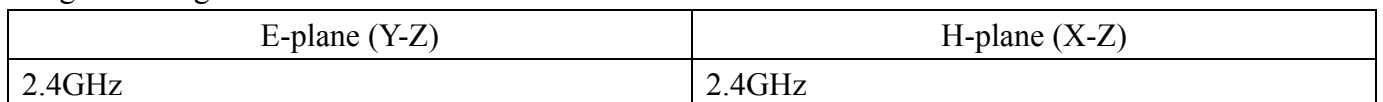

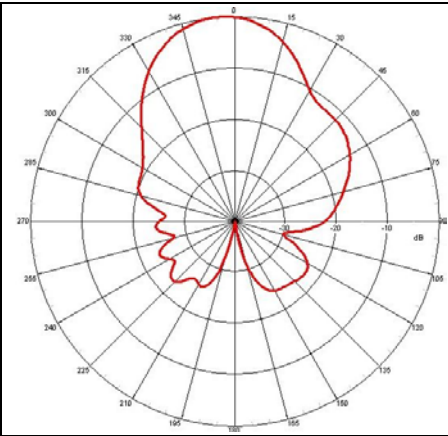
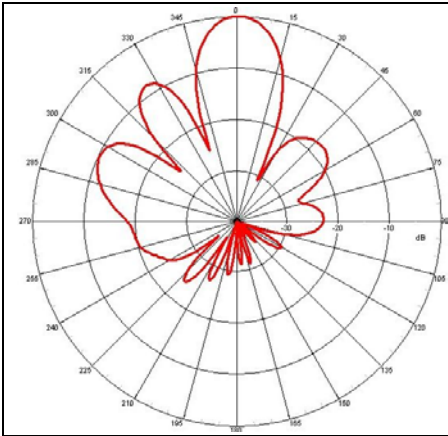

2.45GHz

2.45GHz

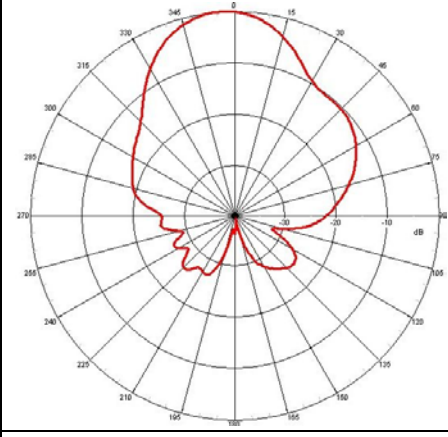
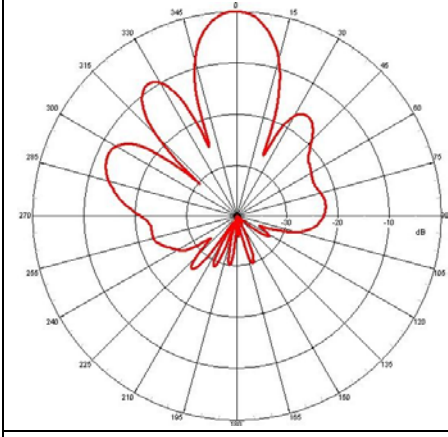

2.5GHz

2.5GHz

Fan angle: 180deg

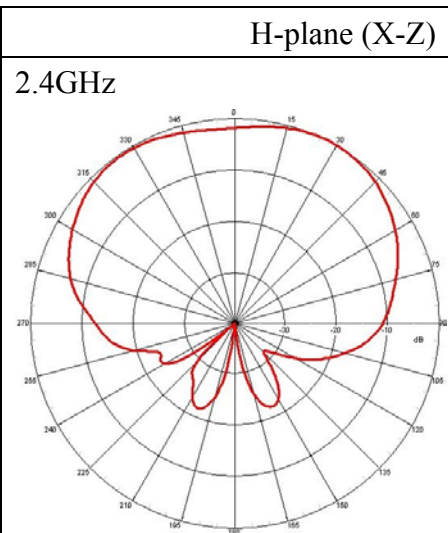
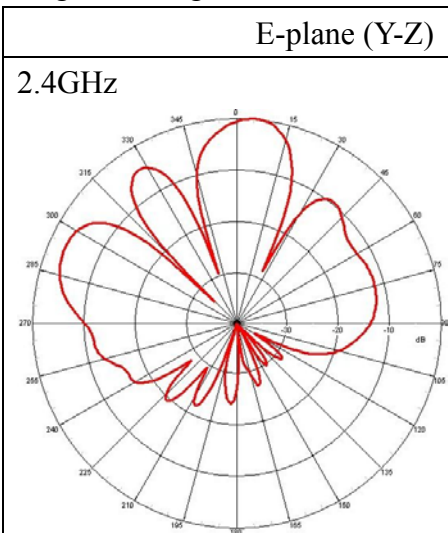

2.45GHz

2.45GHz

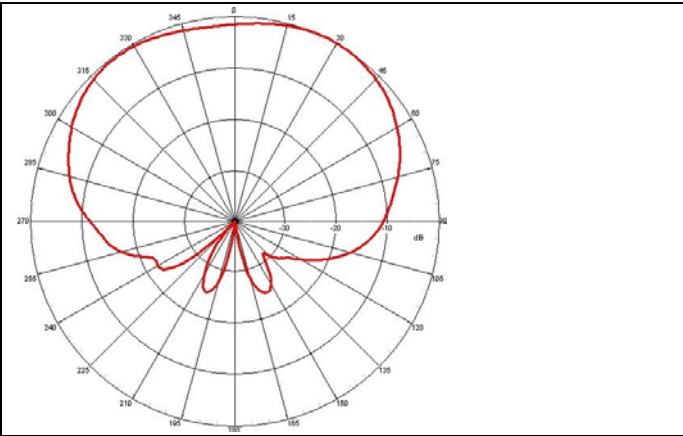
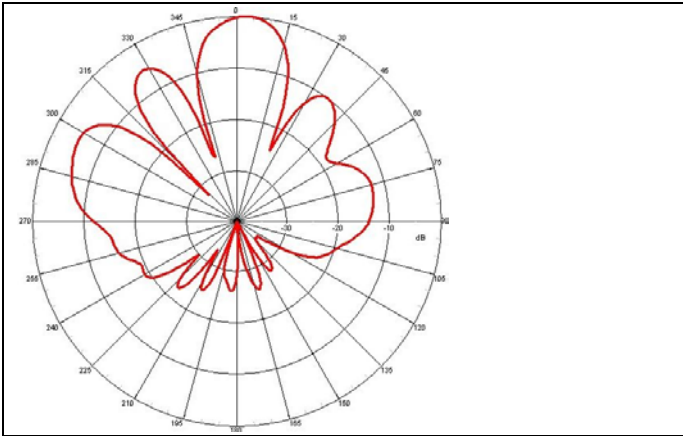

2.5GHz

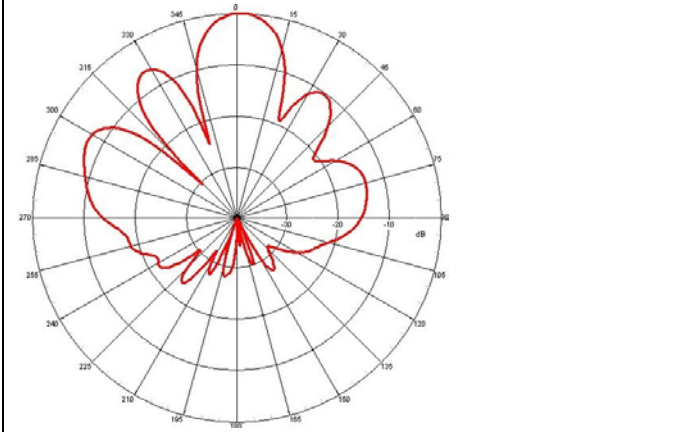

2.5GHz

