

RJ45-ECS

Ethernet connector system



RJ45-ECS

Ethernet connector system



MATING CABLE GLAND WHICH PASSES AN RJ45 CONNECTOR AND SEALS THE CABLE TO IP67 PROTECTION LEVEL



HIGH QUALITY, FLEXIBLE ETHERNET CABLE AWG24, UV/OIL RESISTANT



SHIELDED RJ45 LOW-PROFILE RECEPTACLE MOUNTED IN A UV PROTECTED HOUSING



QUICK AND EASY DISCONNECT AND RECONNECT OF EQUIPMENT, INSTALLER FRIENDLY



RJ45-ECS ETHERNET CONNECTOR SYSTEM IS A FIELD REPLACEABLE OUTDOOR RATED AND SHIELDED ETHERNET CONNECTION SYSTEM FOR HIGH SPEED 10BASE-T 100BASE-T AND 1000BASE-T NETWORKS.

RJ45-ECS WATERPROOF ADAPTER FROM WIRELESS INSTRUMENTS IS HIGH-QUALITY IP67 LEVEL SYSTEM, THE BEST FOR OUTDOOR ENCLOSURES.

OUR WATERPROOF CONNECTOR CAN BE USED OUTDOOR OR INDOOR AS WELL.



APPLICATIONS

- BASE STATION
- CLIENT STATION
- INDOOR/OUTDOOR DATA EQUIPMENT
- 802.3AF POWER OVER ETHERNET SYSTEM
- INDUSTRIAL APPLICATION
- HARSH ENVIRONMENT APPLICATIONS
- INDOOR/OUTDOOR VIDEO SURVEILLANCE



TECHNICAL SPECIFICATIONS

- MATERIAL:** EPDM, NYLON, ABS
- HOLE DIAMETER:** M20 (20MM)
- WEIGHT:** W1 = 58 G
W2 = 78 G
- OPERATING TEMPERATURE:** FROM -40°F TO 80°C
FROM -40°F TO 176°F
- ETHERNET CABLE LENGTH:** L1 = 160 MM
L2 = 380 MM
- ETHERNET CABLE SPECIFICATION:** CAT5E, 24AWG, UV/
OIL RESISTANT



DIMENSIONS (MM)

L1:

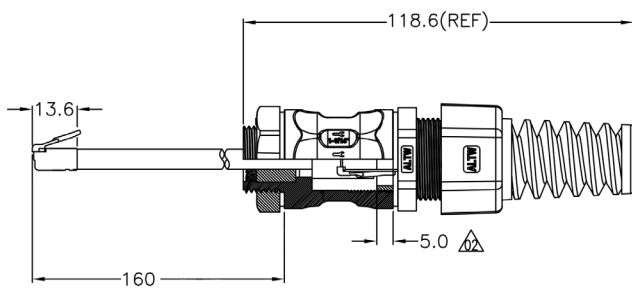

L2:

